

This is what the Tandberg panel looks like in the OFF condition. If the screen is blank, touch the screen to activate it.

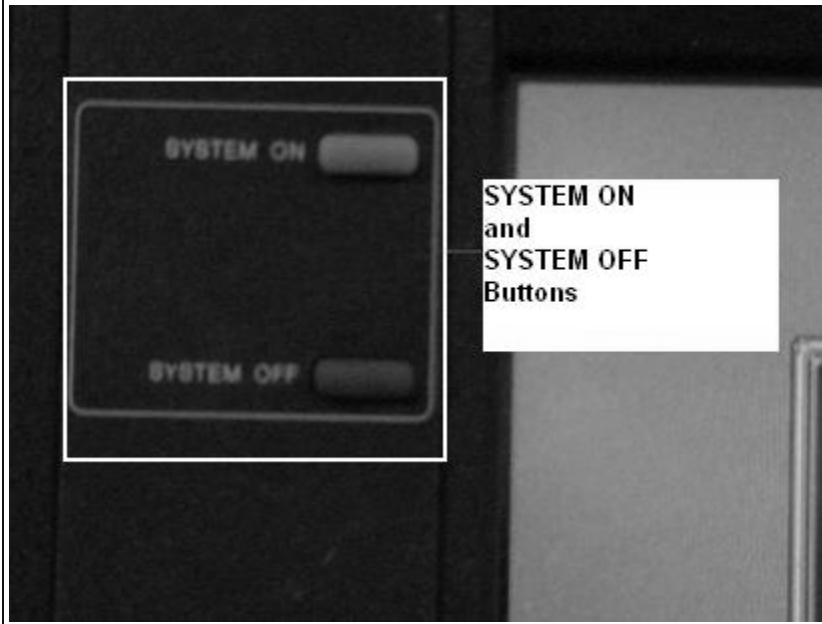

Press the **SYSTEM ON** button to turn on the videoconferencing equipment.



After the system completes the power on cycle, you will see this page on the screen.

Press the **Touch to Start** icon to proceed to the HOME page.



A picture of the HOME screen.

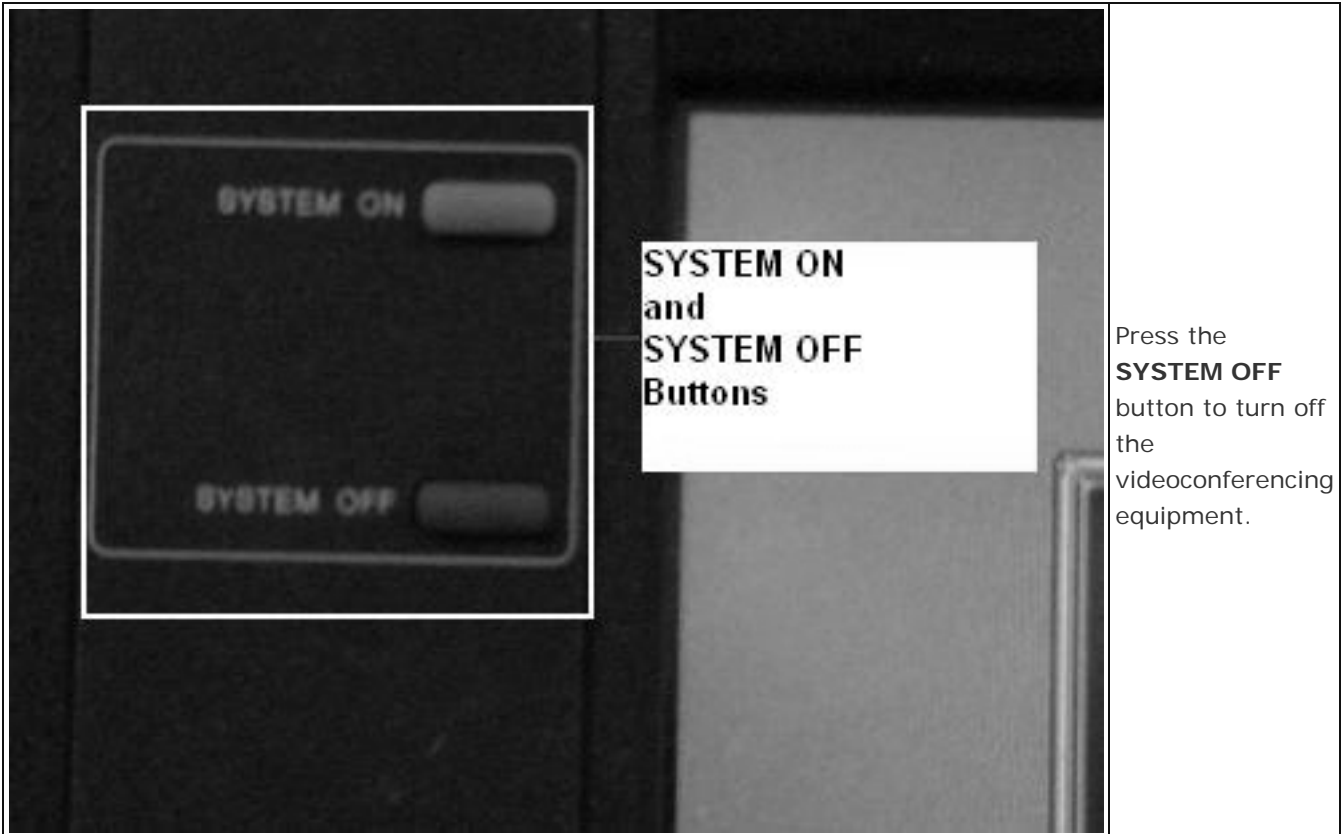

Press the **SYSTEM OFF** button to turn off the videoconferencing equipment.

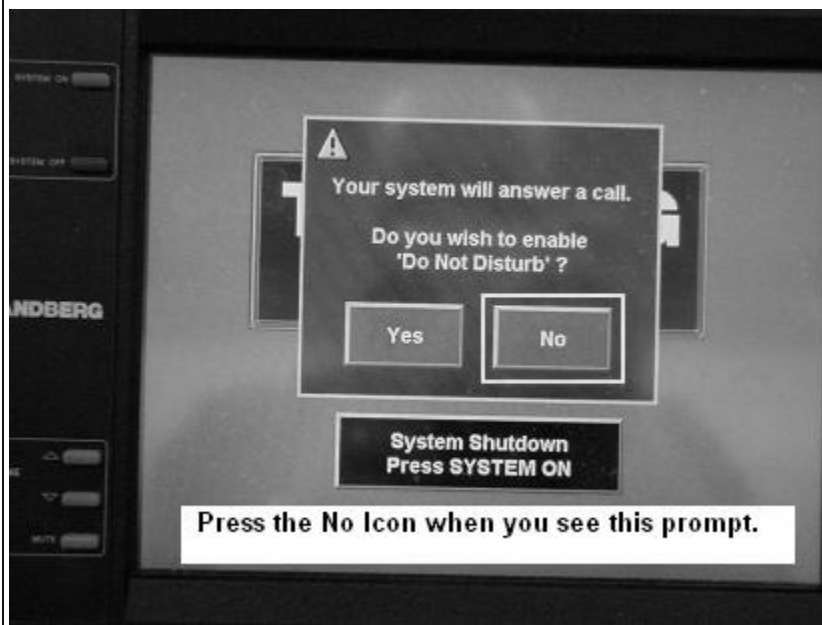

After pressing the **SYSTEM OFF** button, you will see this prompt.

Press the **No** icon.

Note: Pressing the Yes icon will disable the auto-answer feature and prevent automatic connection of the campus location without human intervention.